



Juniper 2x25 Gallon Multi-Engine Compressor Washing Rig Part No. JMP/CFM56/D/4777/C600

This rig is all as per our rig JMP/CFM56/D/4777/C200 but for the following modifications:



The modifications are as follows:

- Actuated ball valves replace the existing manual outlet ball valves for remote operation.
- Remote control with 50m cable complete with Harting fitting for connection to rig (SM903).
- 380/440V. 3 phase, 50hz electrical heating system incorporating control circuit for remote operation.
- Accessory Air Inlet Kit incorporated (JMP/CFM56/D/6612).
- Chassis mounted brackets either side of the rig for external housing of the wash probes consisting of:
 - Horizontal probe mounting bracket (JMP/STD/A/7341) and quick release coupling (SM474)
 - Tubular probe mounting bracket (JMP/STD/A/7342)

Operation

The fluid outlet ball valves fitted to each of the tanks have been replaced with electrically actuated ball valves (220V AC).

These valves are electrically driven and operated automatically. Each valve is equipped with a manual override handwheel which can be used to open and close the valve when the rig is not connected to an electrical supply. To operate the handwheel, press down and make a small rotation to engage the stem. Once manual operation has been engaged you can open and close the valve by maintaining downward pressure and turning the handwheel in the desired direction (the position of the valve can be checked using the visual indicator next to the handwheel).

The control system for heating the tanks to 70°C has been modified to supply power to these valves. No other external power is required to power the valves.

The valves are electrically isolated when the immersion heater ON buttons are pressed, ie: during the heating of the tanks.

A Harting Socket fitted on the underside of the control box enables connection of the remote control box. A 7core, 1.5 mm YY cable (5 cores used) has been provided, one end has a Harting plug for connection to the Harting socket and the other end is for connection to the remote control box.

The remote control box is fitted with two switches, one switch for each valve. Each switch has an open and closed position for the respective valve. From the moment a switch on the remote control is operated, it takes 12 seconds before the respective valve is fully open and 12 seconds before it is fully closed.

Actuated ball valves (SM886)

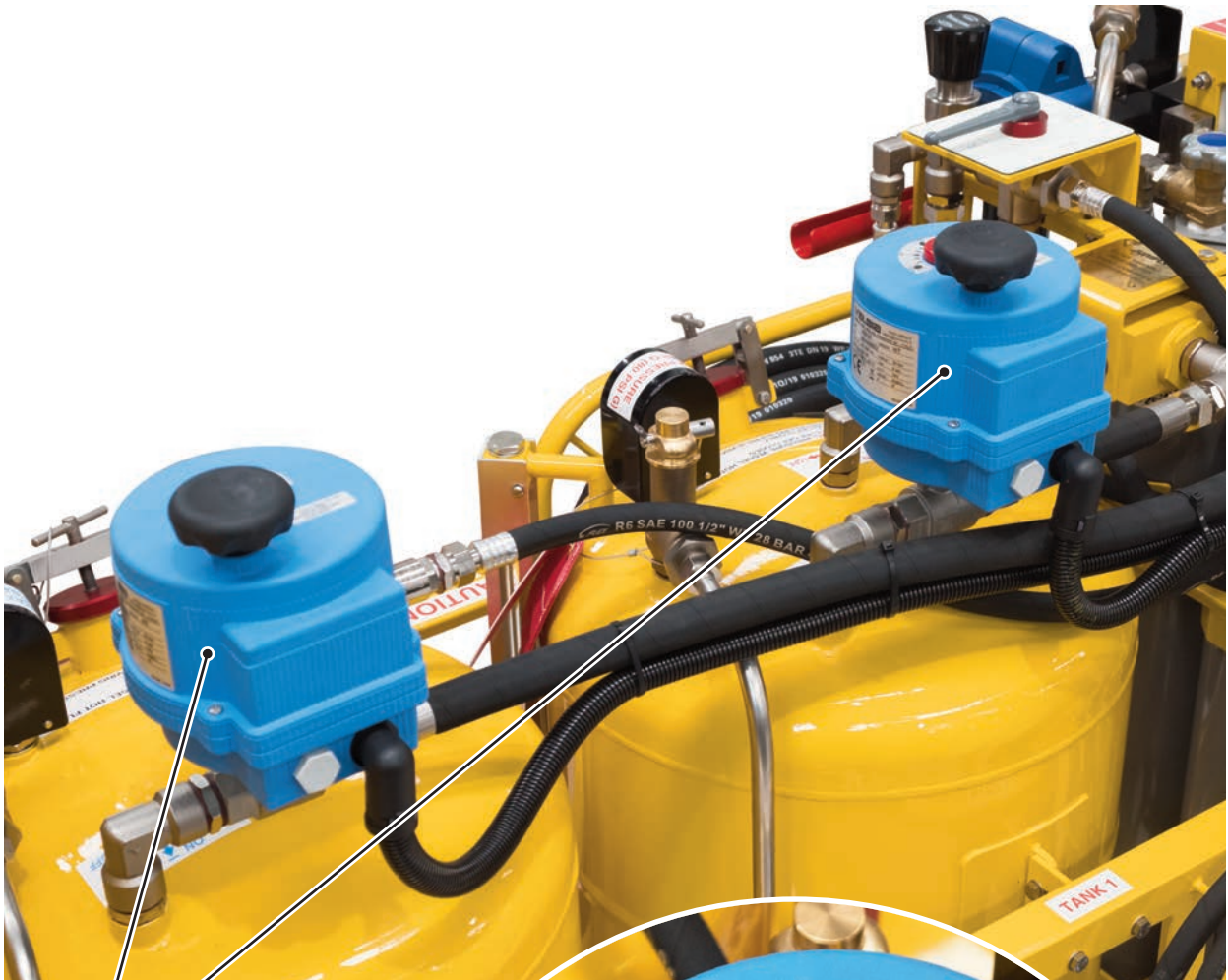

Actuated ball valves - SM886

Manual override handwheel

Valve position indicator



Electrical schematic diagrams

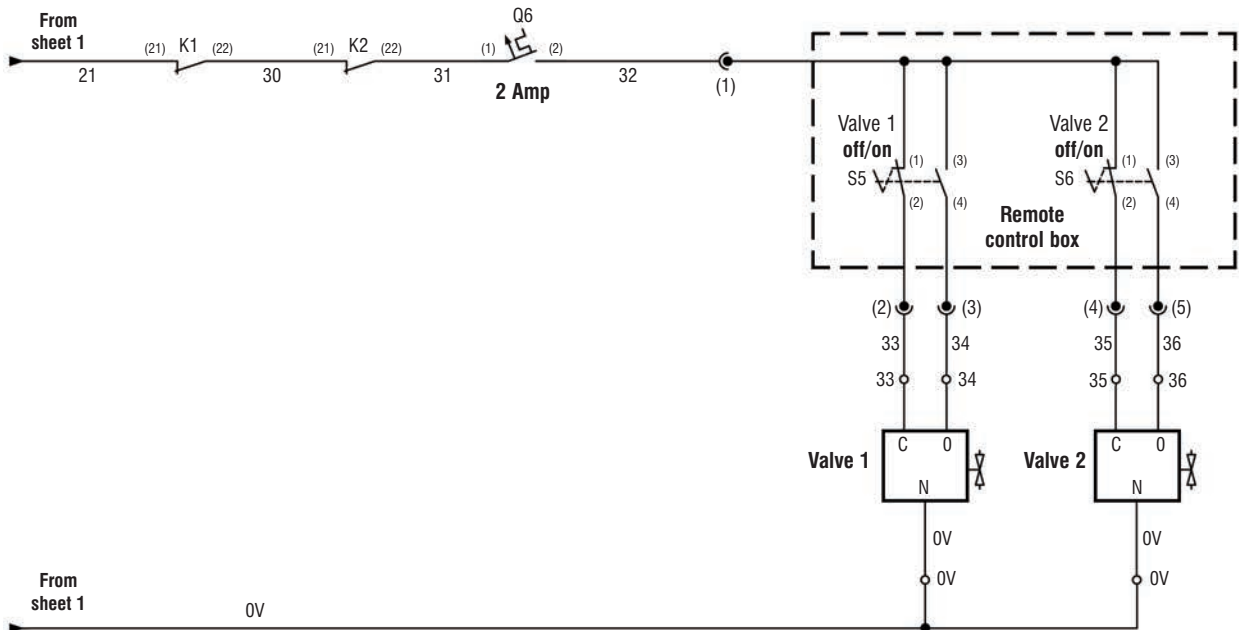
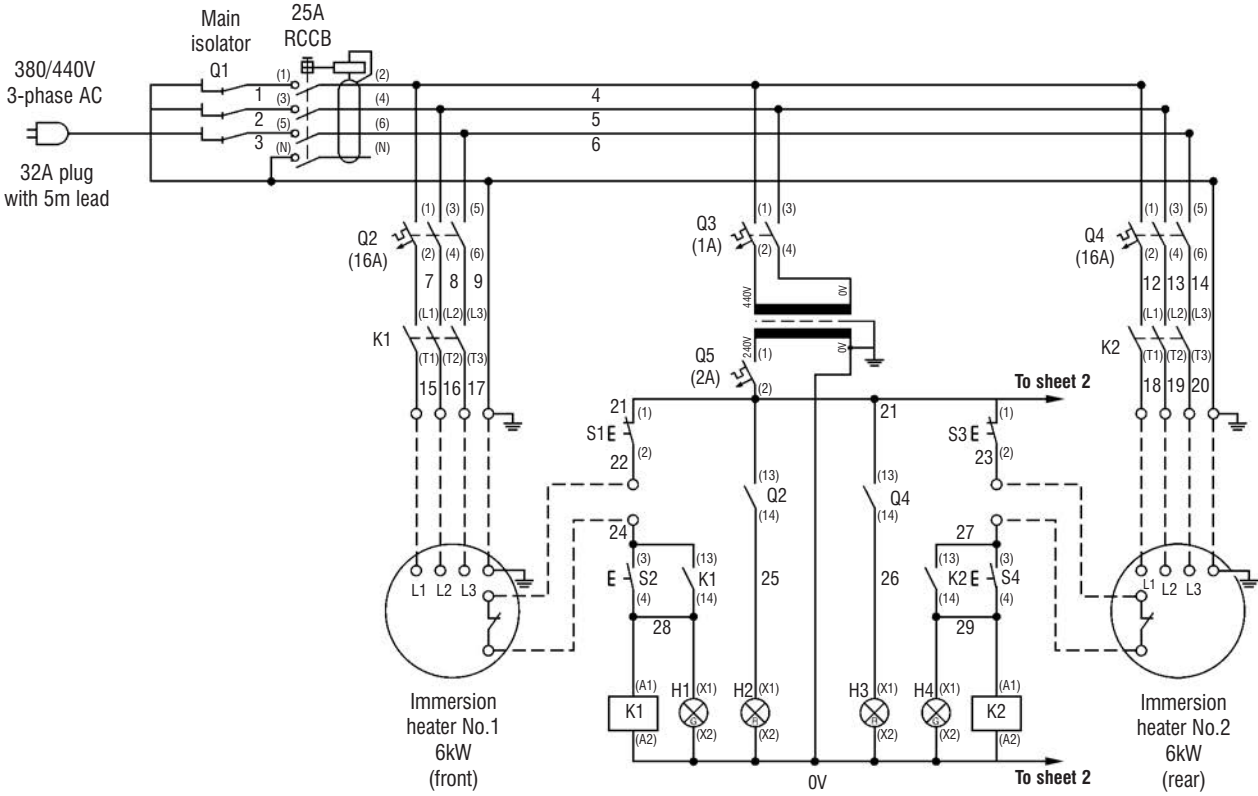

Spare parts list

Item	Manufacturer	Description	Part number	Qty
E1	Legrand	Enclosure	JMP/GE/D/6752/1	1
E1	Legrand	Enclosure Backplate	JMP/GE/D/6752/2	1
RCCB	Merlin	25Amp RCCB 30mA Trip	JMP/GE/D/6752/3	1
RCCB	Sarel	RCCB Enclosure	JMP/GE/D/6752/4	1
Q1	Telemcanique	Door Isolator 32Amp	JMP/GE/D/6752/5	1
Q2	Merlin	MCB 16Amp 3 pole	JMP/GE/D/6752/6	2
Q2	Merlin	MCB Auxiliary	JMP/GE/D/6752/7	1
Q4	Merlin	MCB 16Amp 3 pole	JMP/GE/D/6752/8	1
Q4	Merlin	MCB Auxiliary	JMP/GE/D/6752/9	1
Q3	Merlin	MCB 1Amp 2 pole	JMP/GE/D/6752/10	1
Q5	Merlin	MCB 2Amp 1pole	JMP/GE/D/6752/11	1
K1	Telemcanique	Heater Contactor 25Amp	JMP/GE/D/6752/12	1
K2	Telemcanique	Heater Contactor 25Amp	JMP/GE/D/6752/13	1
S1	Telemcanique	Red PB/Contact block	JMP/GE/D/6752/14	1
S2	Telemcanique	Green PB/Contact block	JMP/GE/D/6752/15	1
S3	Telemcanique	Red PB/Contact block	JMP/GE/D/6752/16	1
S4	Telemcanique	Green PB/Contact block	JMP/GE/D/6752/17	1
H1	Telemcanique	Green Pilot Light	JMP/GE/D/6752/18	1
H2	Telemcanique	Red Pilot Light	JMP/GE/D/6752/19	1
H3	Telemcanique	Red Pilot Light	JMP/GE/D/6752/20	1
H4	Telemcanique	Green Pilot Light	JMP/GE/D/6752/21	1
TX	Legrand	100VA Transformer	JMP/GE/D/6752/22	1
	Contaclip	Outgoing Terminals	JMP/GE/D/6752/23	10
	Contaclip	Earth Terminals	JMP/GE/D/6752/24	2
	Contaclip	End Brackets	JMP/GE/D/6752/25	2
	Contaclip	Din 35 Rail	JMP/GE/D/6752/26	1
	Briticent	8Way Earth Block	JMP/GE/D/6752/27	1
	Iboco	40x40 Slotted Trunking	JMP/GE/D/6752/28	1
		5 Core 4mm SY Cable	JMP/GE/D/6752/29	5m
		7 Core 4mm SY Cable	JMP/GE/D/6752/30	5m
	CMP	SY Cable Glands	JMP/GE/D/6752/31	5
	Telemcanique	Pushbutton Station	JMP/GE/D/6752/32	1
	Telemcanique	2 Way Selector Switch	JMP/GE/D/6752/33	2
	Harting	Plug & Male Insert	JMP/GE/D/6752/34	1
	Harting	Bulkhead & Female Insert	JMP/GE/D/6752/35	1
	Contaclip	Fuse Holder	JMP/GE/D/6752/36	1
F1	Bussman	20mm 2Amp Fuse	JMP/GE/D/6752/37	1
		4core 1.0mm YY Cable	JMP/GE/D/6752/38	5m
		6core 1.5mm SY Cable	JMP/GE/D/6752/39	5m
		M20x1.5 Dome Head Gland	JMP/GE/D/6752/40	2
		M16x1.5 Dome Head Gland	JMP/GE/D/6752/41	2
valve 1/2		Actuated ball valve	SM886	2
	Telemcanique	Remote Control Box XAP M2202	JMP/GE/D/6752/42	1

380/440V, 3 phase, 50hz electrical heating system incorporating control circuit for remote operation. Shown here is the Harting plug connecting the remote control box to the rig's control box via the 50m of electric cable. The remote control, cable and Harting socket have the part number SM903.



The Accessory Air Inlet Kit (JMP/CFM56/D/6612) enabling the connection of an offboard compressed air or nitrogen supply.



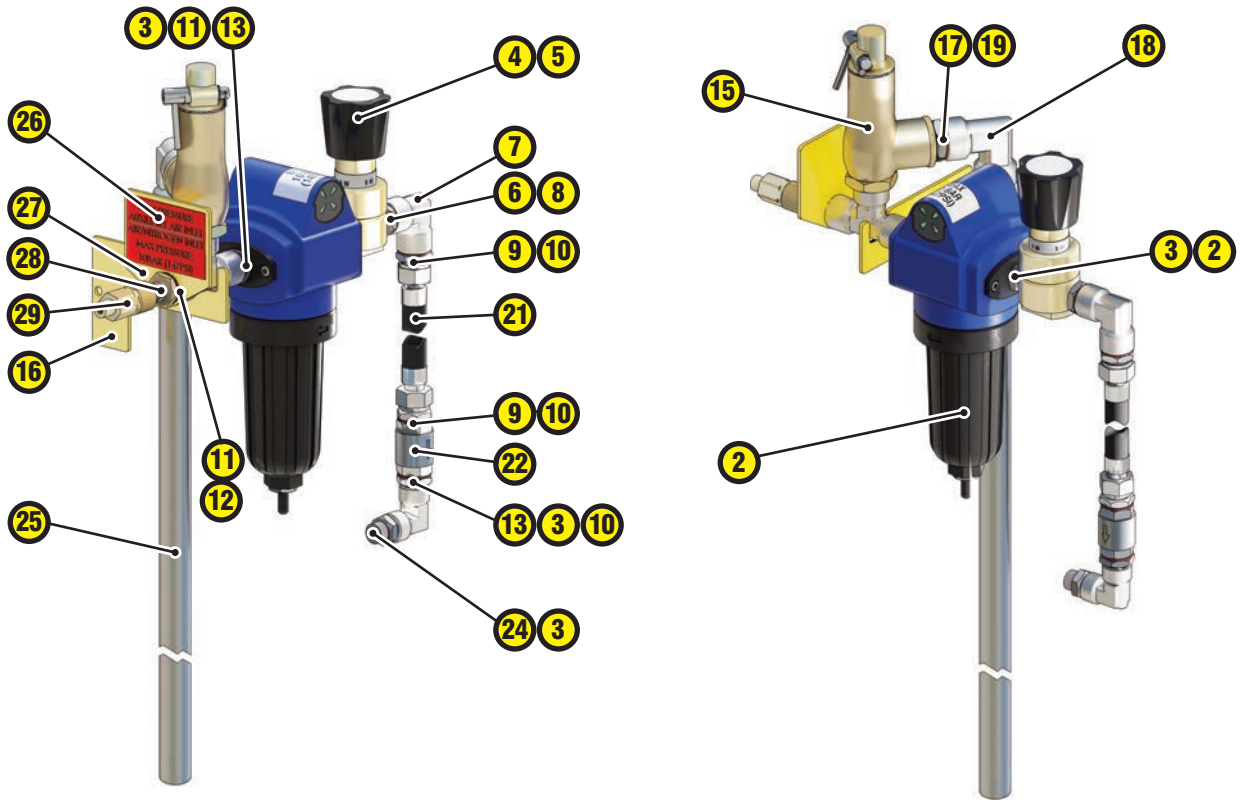

Item no.	Part no.	Description	Quantity
1	SM749	Donaldson filter	1
2	JMP/STD/A/5352	Adaptor, 3/8" BSP x 1/4" BSP	1
3	As supplied	Fibre washer, 16mm I/D x 2mm thick	4
4	SM647/1	Nitrogen inlet regulator valve, 1/4" NPT ports	1
5	SM647/2	Regulator securing nuts	1
6	JMP/STD/A/1686	Adaptor, 1/2" BSP x 1/4" BSP	1
7	SM052	Elbow, 1/2" BSP	1
8	As supplied	Fibre washer, 22mm I/D x 1.5mm thick	1
9	JMP/STD/A/5289	Adaptor, 1/2" BSP x 1/2" BSP	2
10	As supplied	Fibre washer, 21mm I/D x 1.5mm thick	3
11	As supplied	Fibre washer, 19.4mm I/D x 1.5mm thick	3
12	JMP/STD/A/4790	Adaptor, 1/2" BSP (m) x 1/4" BSP (f)	1
13	JMP/STD/A/5353	Adaptor, 1/2" BSP x 3/8" BSP	2
14	SM053	Equal tee, 1/2" BSP	1
15	SM950	Safety relief valve, 150psi metal seats	1
16	JMP/CFM56/A/7082	Safety valve support	1
17	JMP/STD/A/5349	Adaptor	1
18	SM054	Elbow, 3/4" BSP	1
19	As supplied	Fibre washer, 26mm I/D x 1.5mm thick	2
20	As supplied	Warning label, Max 147psi	1
21	JMP/RGT/HL/6827	Hose assembly, 1/2" x 56" (1422mm)	1
22	SM050	Non-return valve	1
23	SM058	Equal elbow, 3/8" BSP	1
24	JMP/STD/A/5141	Adaptor, 3/8" BSP	1
25	JMP/CFM56/D/6612/01	Blow-off tube assembly	1
26	JMP/CFM56/A/7215/2	Traffolyte warning panel	1
27	JMP/CFM56/A/7215/1	Pressure warning plate	1
28	SM726	Quick release plug, 1/4" BSP (m)	1
29	SM724	Quick release socket, 1/4" BSP (m)	1

Chassis mounted brackets either side of the rig for external housing of the wash probes.

