



**Juniper 2x25 Gallon Multi-Engine Compressor Washing Rig
Part No. JMP/CFM56/D/4777/C601**

This rig is all as per our rig JMP/CFM56/D/4777/C200
but for the following modifications:



**The modifications
are as follows:**

- Actuated ball valves replace the existing manual outlet ball valves for remote operation.
- Remote control with 50m cable complete with Harting fitting for connection to rig (SM903).
- 380/440V. 3 phase, 50hz electrical heating system incorporating control circuit for remote operation.
- Accessory Air Inlet Kit incorporated (JMP/CFM56/D/6612).
- Chassis mounted brackets either side of the rig for external housing of the wash probes consisting of:
 - Horizontal probe mounting bracket (JMP/STD/A/7341) and quick release coupling (SM474)
 - Tubular probe mounting bracket (JMP/STD/A/7342).
- Set of LEAP-1 engine wash probes (JMP/LEAP/D/7028).
- Operating instructions and decal set in French.

Operation

The fluid outlet ball valves fitted to each of the tanks have been replaced with electrically actuated ball valves (220V AC).

These valves are electrically driven and operated automatically. Each valve is equipped with a manual override handwheel which can be used to open and close the valve when the rig is not connected to an electrical supply. To operate the handwheel, press down and make a small rotation to engage the stem. Once manual operation has been engaged you can open and close the valve by maintaining downward pressure and turning the handwheel in the desired direction (the position of the valve can be checked using the visual indicator next to the handwheel).

The control system for heating the tanks to 70°C has been modified to supply power to these valves. No other external power is required to power the valves.

The valves are electrically isolated when the immersion heater ON buttons are pressed, ie: during the heating of the tanks.

A Harting Socket fitted on the underside of the control box enables connection of the remote control box. A 7core, 1.5 mm YY cable (5 cores used) has been provided, one end has a Harting plug for connection to the Harting socket and the other end is for connection to the remote control box.

The remote control box is fitted with two switches, one switch for each valve. Each switch has an open and closed position for the respective valve. From the moment a switch on the remote control is operated, it takes 12 seconds before the respective valve is fully open and 12 seconds before it is fully closed.

Actuated ball valves (SM886)

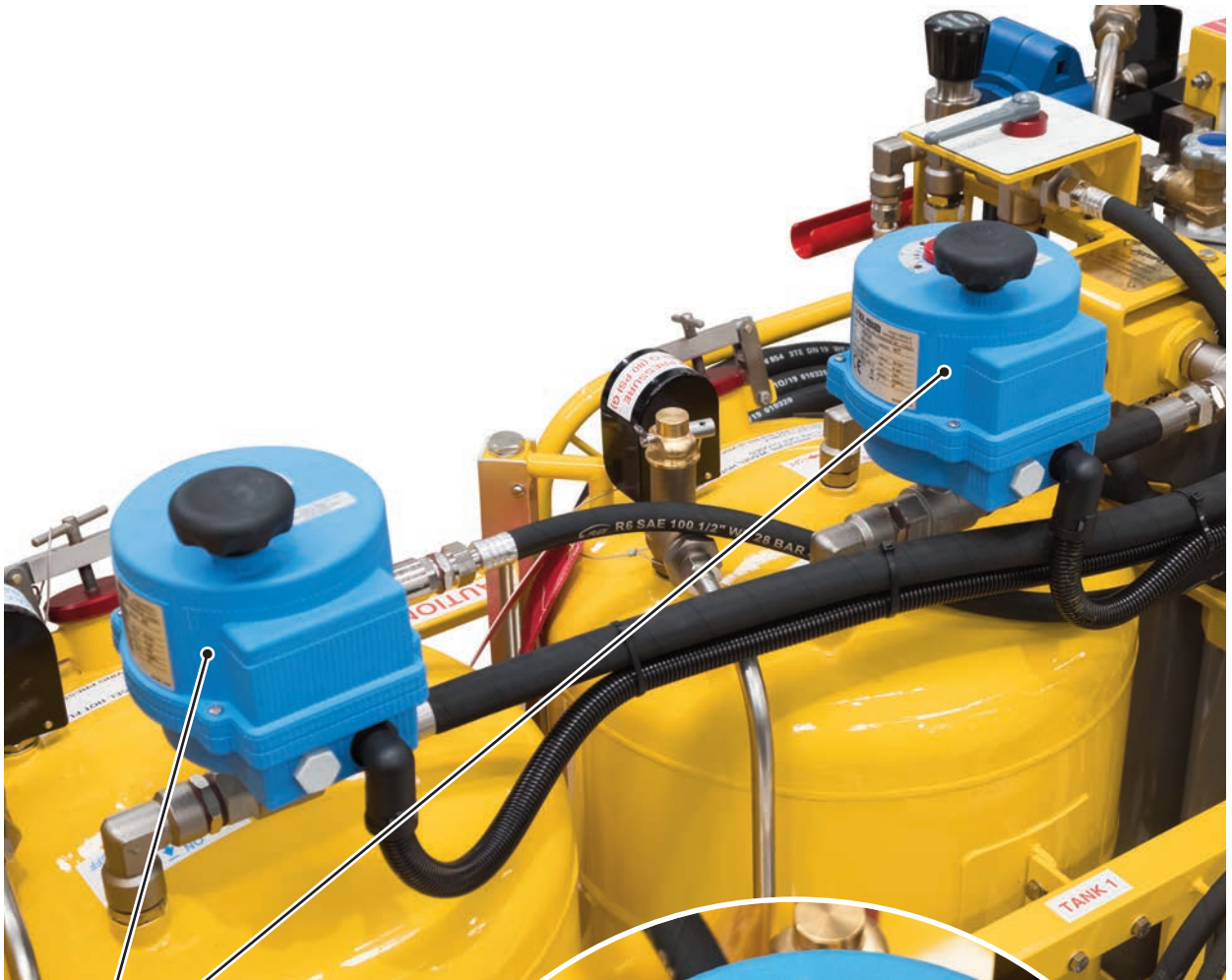

Actuated ball valves - SM886

Manual override
handwheel

Valve position
indicator



Electrical schematic diagrams

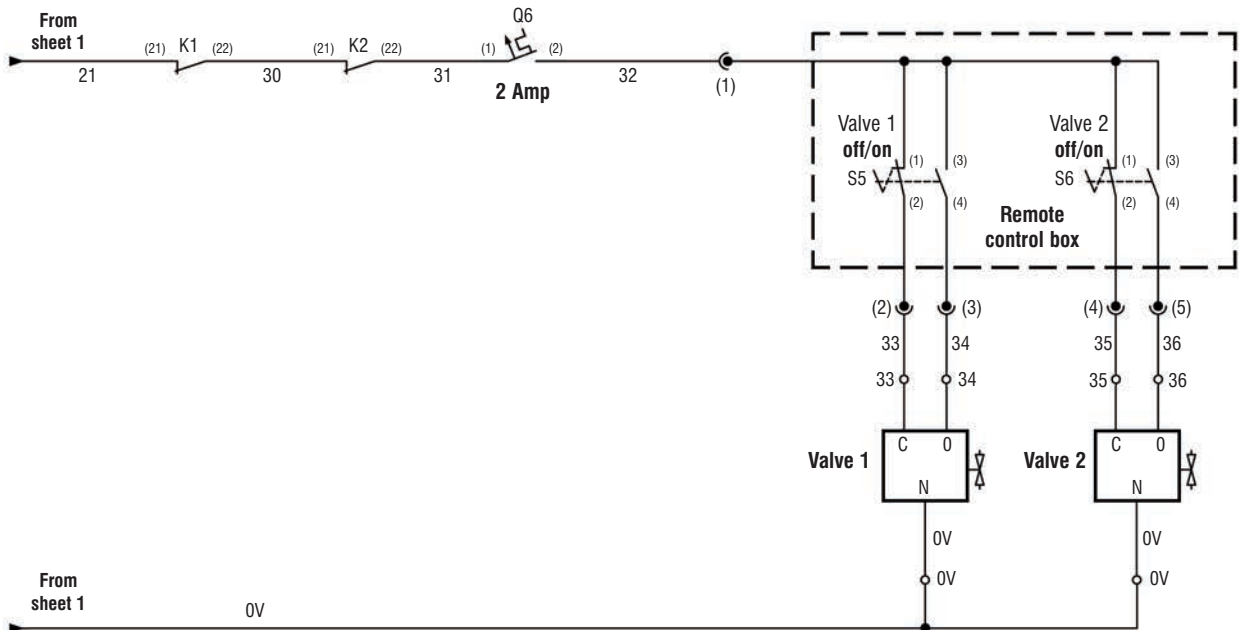
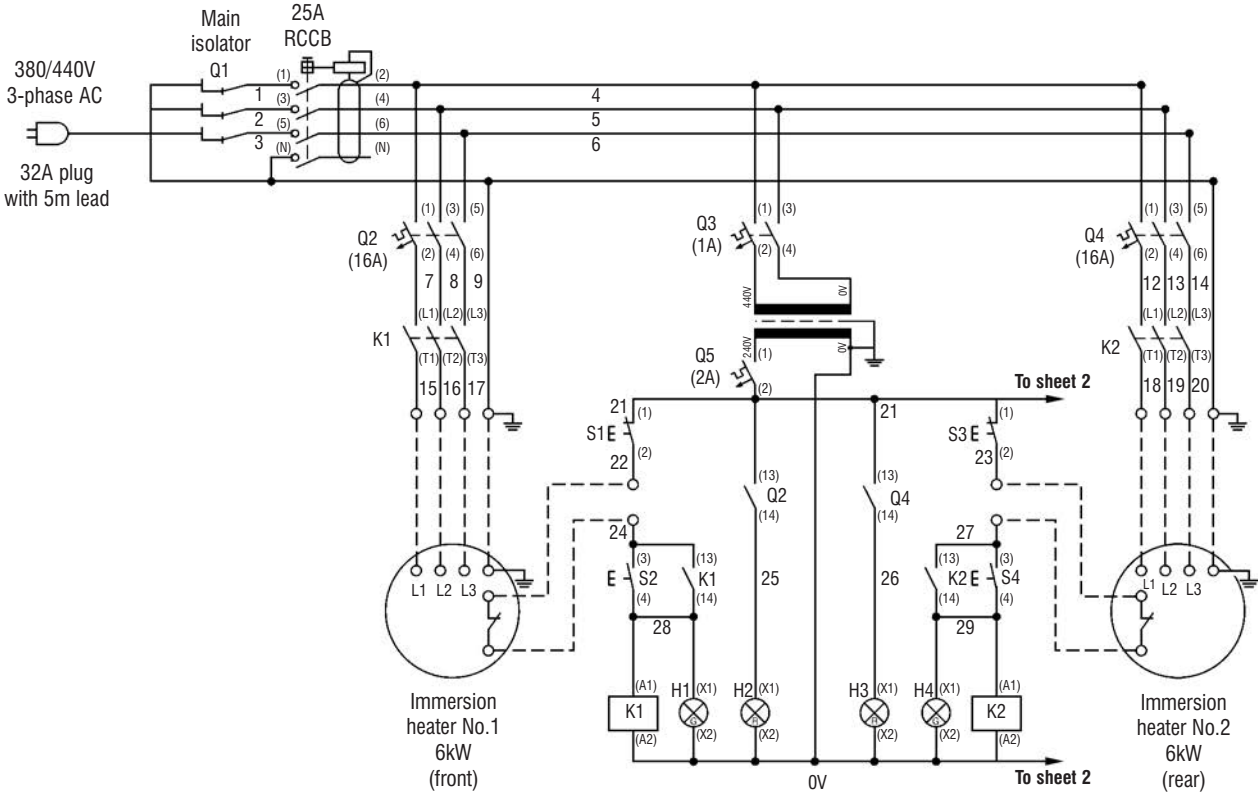

Spare parts list

Article	Fabricant	Description	Reference	Qte
E1	Legrand	Chassis	JMP/SNECMA/D/7059/1	1
E1	Legrand	Plaque du Chassis	JMP/SNECMA/D/7059/2	1
RCCB	Schneider	Residuel Courant Disjoncteur 25A 30mA	JMP/SNECMA/D/7059/3	1
RCCB	Schneider	RCCB Chassis	JMP/SNECMA/D/7059/4	1
Q1	Schneider	Porte Isolateur 32Amp	JMP/SNECMA/D/7059/5	1
Q2	Schneider	Disjoncteur 3pole 16Amp	JMP/SNECMA/D/7059/6	1
Q2	Schneider	Passer Auxiliaire	JMP/SNECMA/D/7059/7	1
Q3	Schneider	Disjoncteur 2pole 1Amp	JMP/SNECMA/D/7059/8	1
Q4	Schneider	Disjoncteur 3pole 16Amp	JMP/SNECMA/D/7059/9	1
Q4	Schneider	Passer Auxiliaire	JMP/SNECMA/D/7059/10	1
Q5	Schneider	Disjoncteur 1pole 2Amp	JMP/SNECMA/D/7059/11	1
K1	Schneider	Chauffage Contacteur 25Amp	JMP/SNECMA/D/7059/12	1
K2	Schneider	Chauffage Contacteur 25Amp	JMP/SNECMA/D/7059/13	1
S1	Schneider	Bouton-Poussoir, Rouge	JMP/SNECMA/D/7059/14	1
S2	Schneider	Bouton-Poussoir, Vert	JMP/SNECMA/D/7059/15	1
S3	Schneider	Bouton-Poussoir, Rouge	JMP/SNECMA/D/7059/16	1
S4	Schneider	Bouton-Poussoir, Vert	JMP/SNECMA/D/7059/17	1
H1	Schneider	Vert Lampe	JMP/SNECMA/D/7059/18	1
H2	Schneider	Rouge Lampe	JMP/SNECMA/D/7059/19	1
H3	Schneider	Rouge Lampe	JMP/SNECMA/D/7059/20	1
H4	Schneider	Vert Lampe	JMP/SNECMA/D/7059/21	1
TX	Legrand	160VA Transformaeur	JMP/SNECMA/D/7059/22	1
	Contaclip	Bornes	JMP/SNECMA/D/7059/23	10
	Contaclip	Bornes de Terre	JMP/SNECMA/D/7059/24	2
	Contaclip	Supports d'extremite	JMP/SNECMA/D/7059/25	2
	Contaclip	Din 35 Rail	JMP/SNECMA/D/7059/26	1
	Briticent	Huit façon bloc de la Terre	JMP/SNECMA/D/7059/27	1
	Iboco	40x40 Trunking	JMP/SNECMA/D/7059/28	1
		Cinq Câble de base 4mm SY	JMP/SNECMA/D/7059/29	5m
		Sept Câble de base 4mm YY	JMP/SNECMA/D/7059/30	5m
	CMP	SY Cable Glands	JMP/SNECMA/D/7059/31	5
S5	Schneider	Selecteur	JMP/SNECMA/D/7059/32	1
S6	Schneider	Selecteur	JMP/SNECMA/D/7059/33	1
E2	Schneider	Panneua de Commande Distance	JMP/SNECMA/D/7059/34	1
		Sept Câble de base 0.75mm YY	JMP/SNECMA/D/7059/35	50m
	Harting	Han E Series 6 Way Fische Mâle	JMP/SNECMA/D/7059/36	1
	Harting	Han E Series 6 Way Presse Femelle	JMP/SNECMA/D/7059/37	1
	Stäubli	prise	SM947/1	1
	Stäubli	fiche	SM947/2	1

380/440V, 3 phase, 50hz electrical heating system incorporating control circuit for remote operation. Shown here is the Harting plug connecting the remote control box to the rig's control box via the 50m of electric cable. The remote control, cable and Harting socket have the part number SM903.



The Accessory Air Inlet Kit (JMP/CFM56/D/6612) enabling the connection of an offboard compressed air or nitrogen supply.



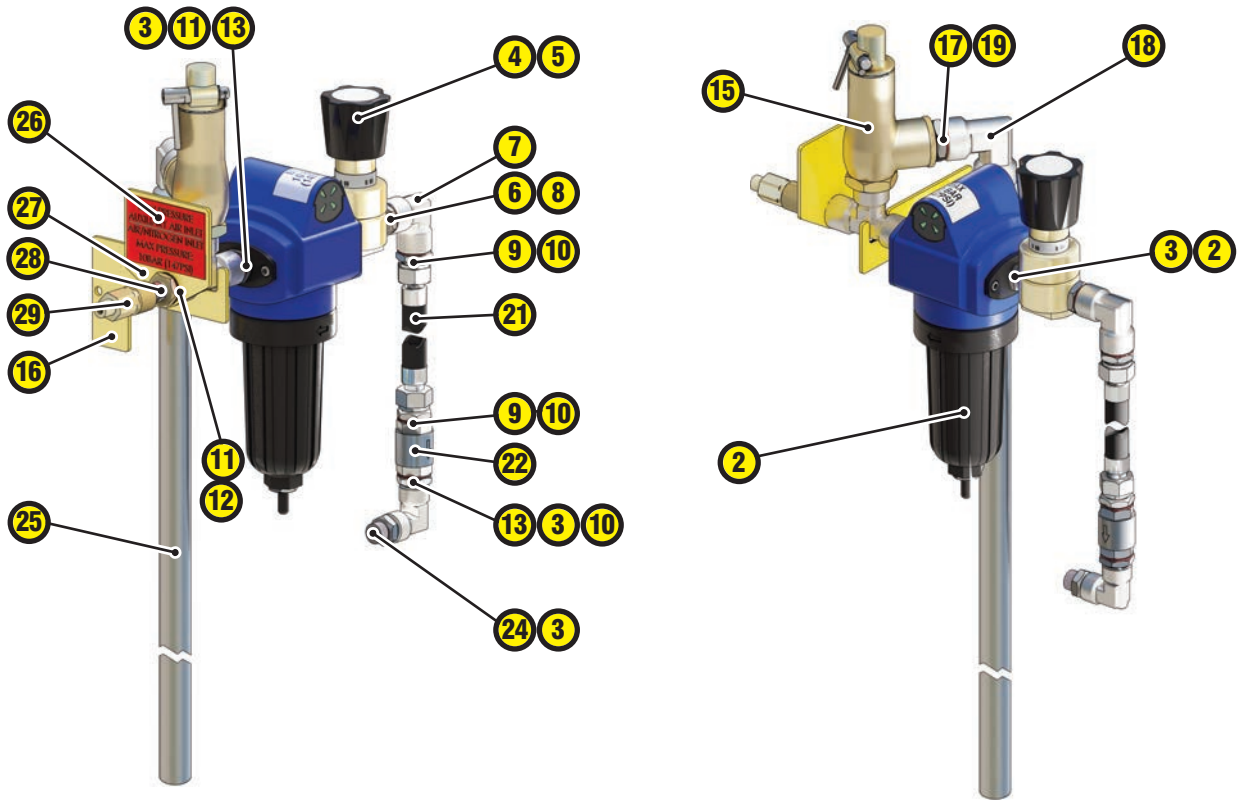

Item no.	Part no.	Description	Quantity
1	SM749	Donaldson filter	1
2	JMP/STD/A/5352	Adaptor, 3/8" BSP x 1/4" BSP	1
3	As supplied	Fibre washer, 16mm I/D x 2mm thick	4
4	SM647/1	Nitrogen inlet regulator valve, 1/4" NPT ports	1
5	SM647/2	Regulator securing nuts	1
6	JMP/STD/A/1686	Adaptor, 1/2" BSP x 1/4" BSP	1
7	SM052	Elbow, 1/2" BSP	1
8	As supplied	Fibre washer, 22mm I/D x 1.5mm thick	1
9	JMP/STD/A/5289	Adaptor, 1/2" BSP x 1/2" BSP	2
10	As supplied	Fibre washer, 21mm I/D x 1.5mm thick	3
11	As supplied	Fibre washer, 19.4mm I/D x 1.5mm thick	3
12	JMP/STD/A/4790	Adaptor, 1/2" BSP (m) x 1/4" BSP (f)	1
13	JMP/STD/A/5353	Adaptor, 1/2" BSP x 3/8" BSP	2
14	SM053	Equal tee, 1/2" BSP	1
15	SM950	Safety relief valve, 150psi metal seats	1
16	JMP/CFM56/A/7082	Safety valve support	1
17	JMP/STD/A/5349	Adaptor	1
18	SM054	Elbow, 3/4" BSP	1
19	As supplied	Fibre washer, 26mm I/D x 1.5mm thick	2
20	As supplied	Warning label, Max 147psi	1
21	JMP/RGT/HL/6827	Hose assembly, 1/2" x 56" (1422mm)	1
22	SM050	Non-return valve	1
23	SM058	Equal elbow, 3/8" BSP	1
24	JMP/STD/A/5141	Adaptor, 3/8" BSP	1
25	JMP/CFM56/D/6612/01	Blow-off tube assembly	1
26	JMP/CFM56/A/7215/2	Traffolyte warning panel	1
27	JMP/CFM56/A/7215/1	Pressure warning plate	1
28	SM726	Quick release plug, 1/4" BSP (m)	1
29	SM724	Quick release socket, 1/4" BSP (m)	1

Chassis mounted brackets either side of the rig for external housing of the wash probes.

