

**THE JUNIPER
TRENT 1000 LONG ENGINE
WASH PROBES
JMP/TRENT/D/6754**

(Supplied as set of two)

Fitment Guide

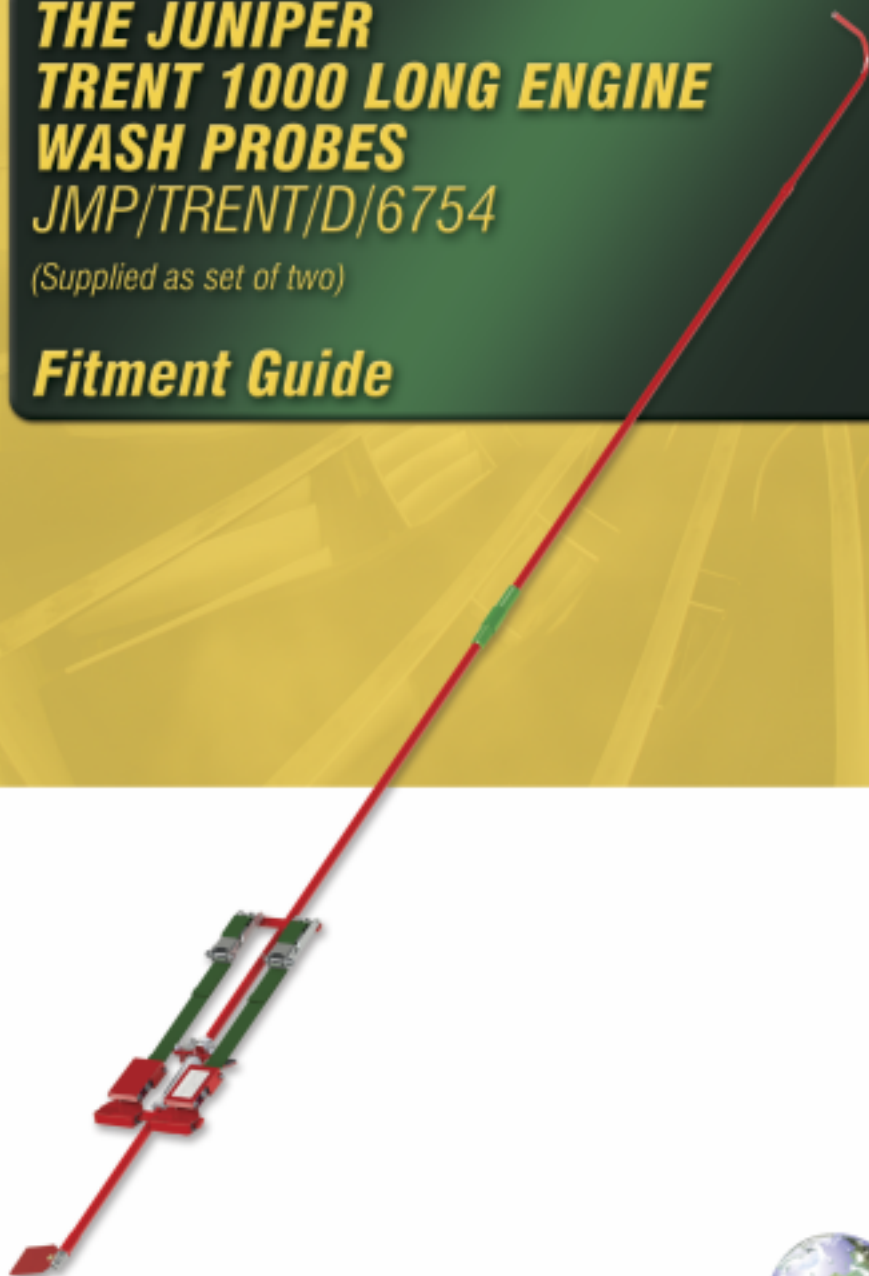

AIRCRAFT SERVICE EQUIPMENT



The TRENT 1000 long engine wash probes **JMP/TRENT/D/6754**

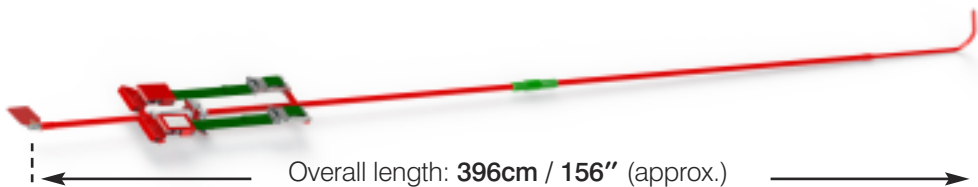

STEP 1: Assembling the probes

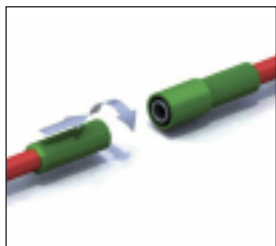

Connect probe halves by screwing together, ensuring a tight fit.



The screw connections require occasional greasing with an anti-seize compound such as Copaslip™ or equivalent grease. Take care not to get any compound in the bore of the connector.

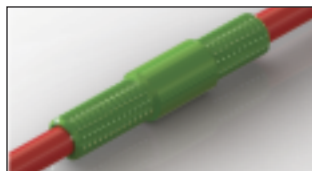

Probes are supplied in sets of two and are identified by a red connection (port side) and green connection (starboard side).

STEP 2: Probe fitment

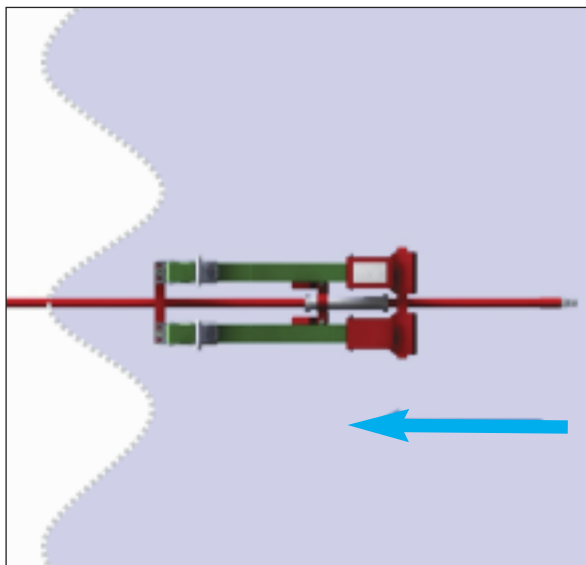

Feed the Port Probe (red connector) into the port side of the engine so that the hook fits between the outlet guide vanes and over the booster splitter, as shown here.

STEP 3: Securing the probe clamp

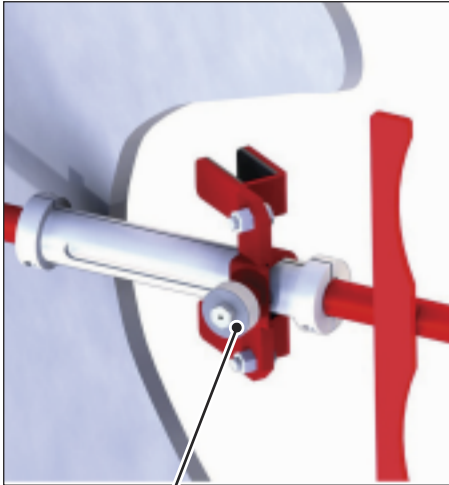

Knurled clamping screw

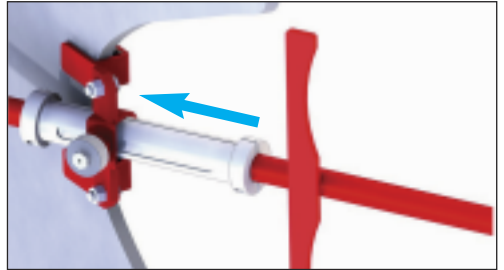

Turn the knurled clamping screw anti-clockwise so the probe clamp becomes loose enough to slide along the aluminium collar. Slide the probe clamp over the translating sleeve, as shown here.

Turn the knurled clamping screw to tighten and secure the clamp in position.

STEP 4: Securing the spring clamps

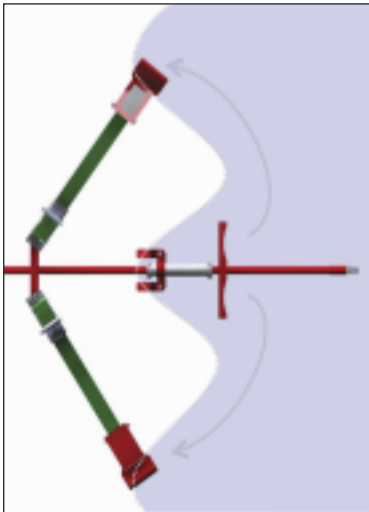

Spring clamps prevent over-tightening when fitting each probe.

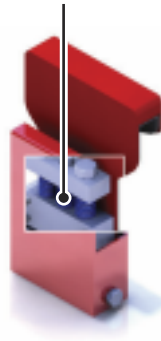

Unfasten the spring clamps, position them as shown and tighten to secure the engine wash probe in place.

Repeat steps 1 & 2 for Starboard Probe.

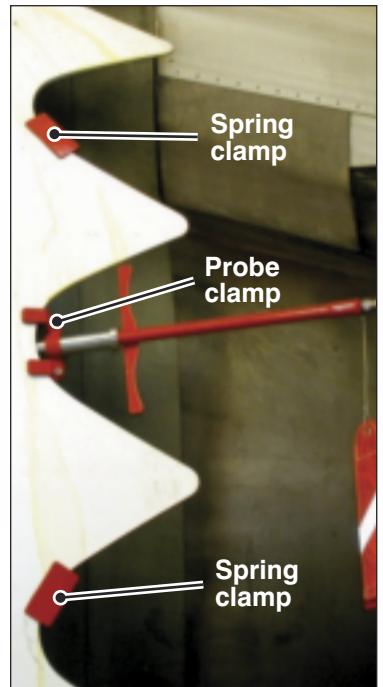

STEP 5: Attaching the twin delivery hose

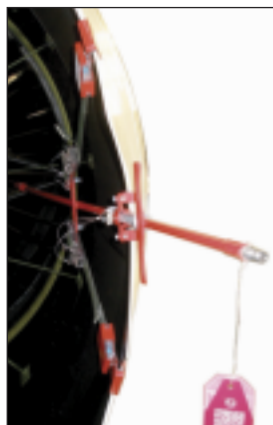

Starboard side

When both port and starboard probes have been securely fitted at the **9 o'clock** and **3 o'clock** positions, respectively, attach the twin delivery hose (supplied with all compressor wash rigs) and proceed with the engine wash.

Follow the operating instructions on the compressor wash rig to complete the wash.

(Viewed from aft looking forward)

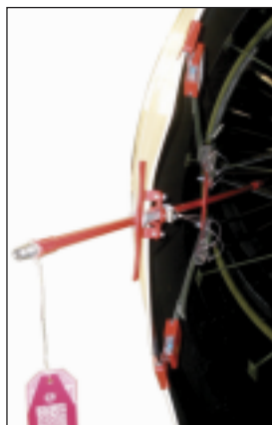

Port side

Delivery hose selection



When using Trent 1000 long engine wash probes, turn the three way selector to position '**A**' this ensures selection of the $\frac{3}{4}$ " bore delivery hose.

Please refer to the relevant AMM for correct flow rate information.

Contact details



Contractors to
H.M. Government Departments
Registered with ISO 9001:2015

A.T.Juniper (Liverpool) Limited

Aircraft Service Equipment

Marshall Works,
11A Prenton Way
North Cheshire Trading Estate,
Prenton, Wirral CH43 3DU
England

Tel: +44 (0)151 733 1553

Email: gse@juniper-liverpool.com

Web: www.juniper-liverpool.com